

S5000 AC Switch - disconnecter base mounting 3P - 3P+N

Size 4

A 1000|1250|1600|1800|2000

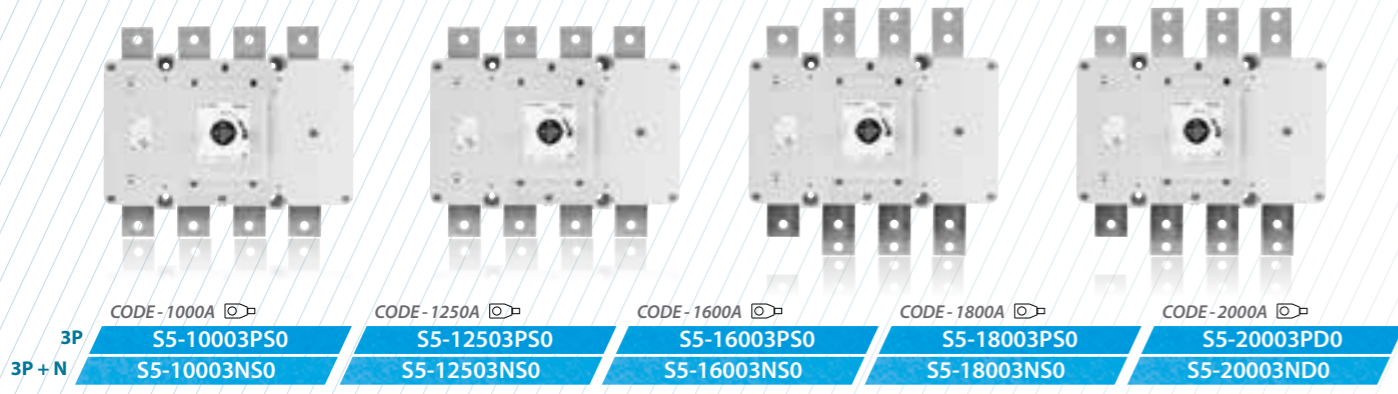

CODE-1000A	CODE-1250A	CODE-1600A	CODE-1800A	CODE-2000A
3P S5-10003PS0	S5-12503PS0	S5-16003PS0	S5-18003PS0	S5-20003PD0
3P+N S5-10003NS0	S5-12503NS0	S5-16003NS0	S5-18003NS0	S5-20003ND0

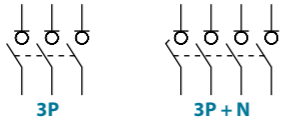

Technical information



According to IEC/EN 60947-3

		1000 1250 1600 1800 2000						
Rated thermal current in ambient at	Ith	40 °C	A	1000	1250	1600	1800	2000
		50 °C	A	1000	1250	1600	1620	1800
		60 °C	A	1000	1000	1440	1440	1600
Rated insulation voltage	Ui	V	1000	1000	1000	1000	1000	
Rated dielectric strength	50 Hz., 1 min.	V	10000	10000	10000	10000	10000	
Rated impulse withstand voltage	Uimp	kV	12	12	12	12	12	
AC rated operational current ^{*(1)}	le	Ue 400V AC21A	A	1000	1250	1600	1800	2000
		Ue 400V AC22A	A	1000	1250	1600	1800	2000
		Ue 400V AC23A	A	1000	1000	1000	1250	1250
		Ue 500V AC21A	A	1000	1250	1600	1800	2000
		Ue 500V AC22A	A	1000	1000	1250	1600	1800
	Ue 500V AC23A	A	800	800	900	1000 ^{*(5)}	1000 ^{*(5)}	

^{*(1)} Other voltages and / or utilization categories. Please consult
^{*(2)} Indicative values: current values vary from one motor manufacturer to another
^{*(3)} Without limiting protective device (short-circuit maintained 50... 100 ms.)
^{*(4)} Please consult us for more operations
^{*(5)} Rated operational current AC22B

		1000 1250 1600 1800 2000						
AC rated operational power ^{*(2)}	Pe	3x400V AC23A	kW	554,2	554,2	554,2	692,8	692,8
Rated capacitor power	400V, sen φ = 0,65	kVAr	450,3	450,3	450,3	562,9	562,9	
Rated breaking capacity	400V AC23A	A	8000	8000	8000	10000	10000	
Rated making capacity	400V AC23A	A	10000	10000	10000	12500	12500	
Short - circuit behaviour								
Rated short-circuit making capacity ^{*(3)}	lcm	kA (peak)	60	60	75	75	75	
Rated short-time withstand current (1sec.)	lcw	kA rms	25	25	50	50	50	
Mechanical features								
Minimum number of mechanical operations ^{*(4)}	Cycles	10000	10000	4500	4500	4500		
Maximum weight 3P	Kg	18,5	18,5	18,5	18,5	18,5		
Maximum weight 3P+N	Kg	20,8	20,8	20,8	20,8	20,8		

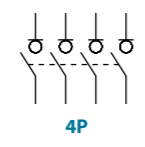

Also available 4P switches under request, consult reference



Accessories

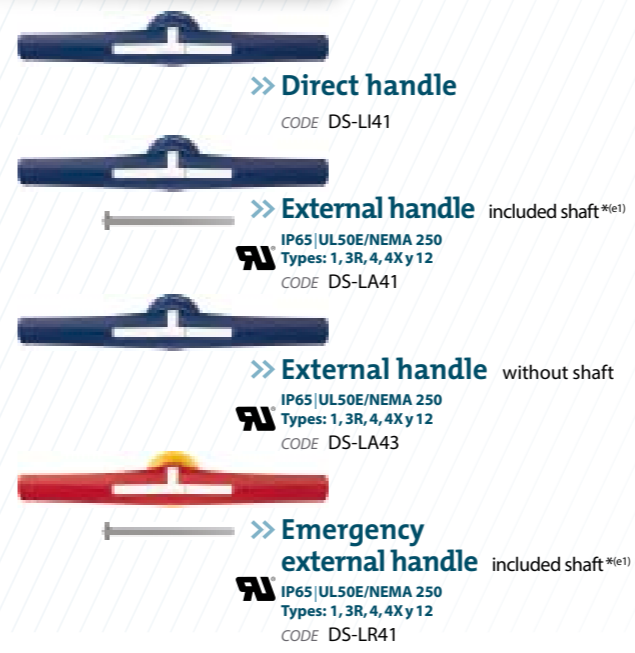

Direct handle
CODE DS-LI41

External handle included shaft ^{*(e1)}
IP65|UL50E/NEMA 250
Types: 1, 3R, 4, 4X y 12
CODE DS-LA41

External handle without shaft
IP65|UL50E/NEMA 250
Types: 1, 3R, 4, 4X y 12
CODE DS-LA43

Emergency external handle included shaft ^{*(e1)}
IP65|UL50E/NEMA 250
Types: 1, 3R, 4, 4X y 12
CODE DS-LR41

Terminal shrouds
CODE DS-CU41
(1 kit for input or output)

Auxiliary contacts
1NO+1NC CODE D5LAU01
2NO+2NC CODE D5LAU02
Ie = 16 A (resistive loads)
4 A (inductive loads) at 250 Vac.

Safety key lock device
Simple CODE DS-CB41
Double CODE DS-CF41

For external handle, lock the handle by means of a key in position "OFF" (under request, in "ON"), the key can only be removed with the handle locked

Door drilling for handle and keylock device
Simple Double

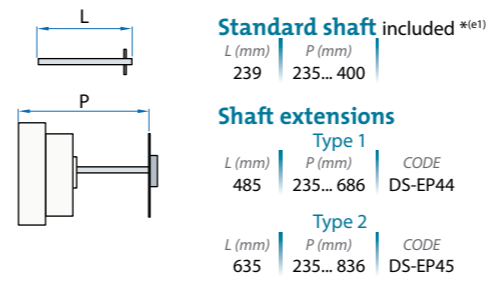

Standard shaft included ^{*(e1)}
L (mm) | P (mm) |
239 | 235... 400

Shaft extensions
Type 1
L (mm) | P (mm) | CODE
485 | 235... 686 | DS-EP44

Type 2
L (mm) | P (mm) | CODE
635 | 235... 836 | DS-EP45

Dimensions (mm)

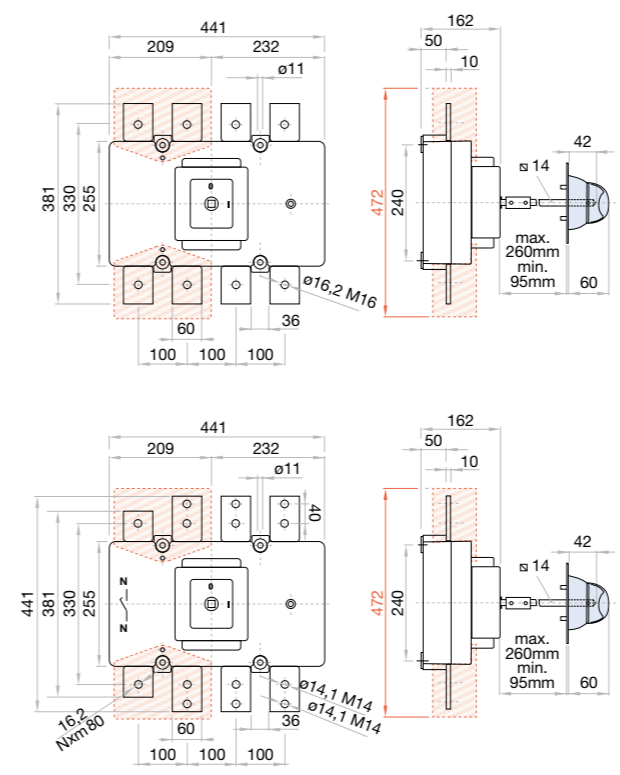

Door drilling for external handle

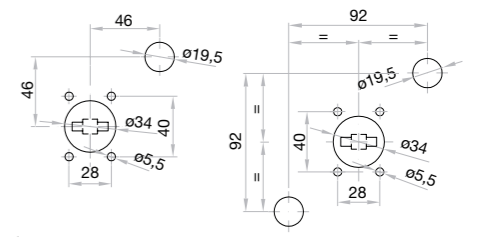
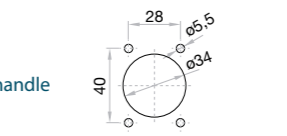

	H max (Cu)	L max (Cu)	M
1000 A	2x7	80	M16
1250 A	2x7	80	M16

	H max (Cu)	L max (Cu)	M
1600 A	2x7	80	M14
1800 A	2x7	80	M14
2000 A	2x7	80	M14