

Product Description

- ◆ TRIAC Output
- ◆ Optical Isolation
- ◆ Dielectric Strength: 2500Vrms
- ◆ Load Current: 1A, 2A
- ◆ PCB or Socket Mounted
- ◆ Load Voltage: 240VAC
- ◆ RoHS Compliant

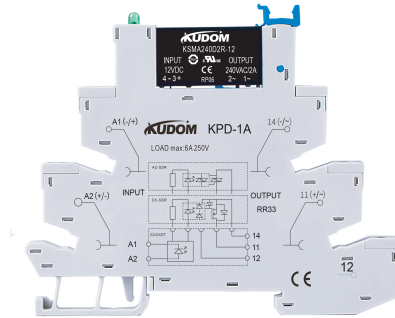

Ordering Information

KSM	A	240	D	1	R	-5	D
KSM Series	Load Type A: AC Load	Load Voltage 240: 240VAC	DC Control	Load Current 1: 1Amp 2: 2Amp	Switching Mode Blank: Zero Crossing R: Random-on	Control Voltage 5: 5VDC 12: 12VDC 24: 24VDC	Blank: without Socket D: with Socket

General Specifications

Input Specifications (Ta=25°C)		
Control Voltage Range (1)	-5	4-6VDC
	-12	9.6-14.4VDC
	-24	19.2-28.8VDC
Must Turn-On Voltage (2)	-5	4VDC
	-12	9.6VDC
	-24	19.2VDC
Must Turn-Off Voltage	1VDC	
Maximum Input Current	25mA	

Note: (1) For KSMD with control voltage at 12V, 24V equipped with the socket, the control voltage limit should be increased by 1.4V, for example, for KSMD24D4-12D, please ensure that the control voltage is 9.6V+1.4V=11V Min.
(2) For KSMDXXDX-5, with socket or without socket the control voltage limit is still 4V, no need to add 1.4V.

Output Specifications (Ta=25°C)		
Load Voltage Range	24-280VAC	
Maximum Transient Overvoltage	600Vpk	
Load Current Range	1A	0.1 - 1A
	2A	0.1 - 2A
Maximum Turn-On Time	Zero Crossing	10ms
	Random-on	1ms
Maximum Turn-Off Time	10ms	
Maximum Surge Current (@10 ms)	1A	30A
	2A	80A
Maximum Off-State Leakage Current @ Rated Load Voltage	1.5mA	
Maximum On-State Voltage Drop @ Rated Current	1.5Vrms	
Minimum Off-State dv/dt @ Maximum Rated Voltage	200V/μs	

General Specifications

General Specifications (Ta=25°C)		
Dielectric Strength (50/60Hz)	2500Vrms	
Minimum Insulation Resistance (@500VDC)	1000MΩ	
Ambient Temperature Range	-30°C ~ +80°C	
Storage Temperature Range	-30°C ~ +100°C	
Weight (Typical)	without Socket	4g
	D: with Socket	30g

Applications

Suitable for high density PCB mounting, PLC control applications, and etc.

Outline Dimensions

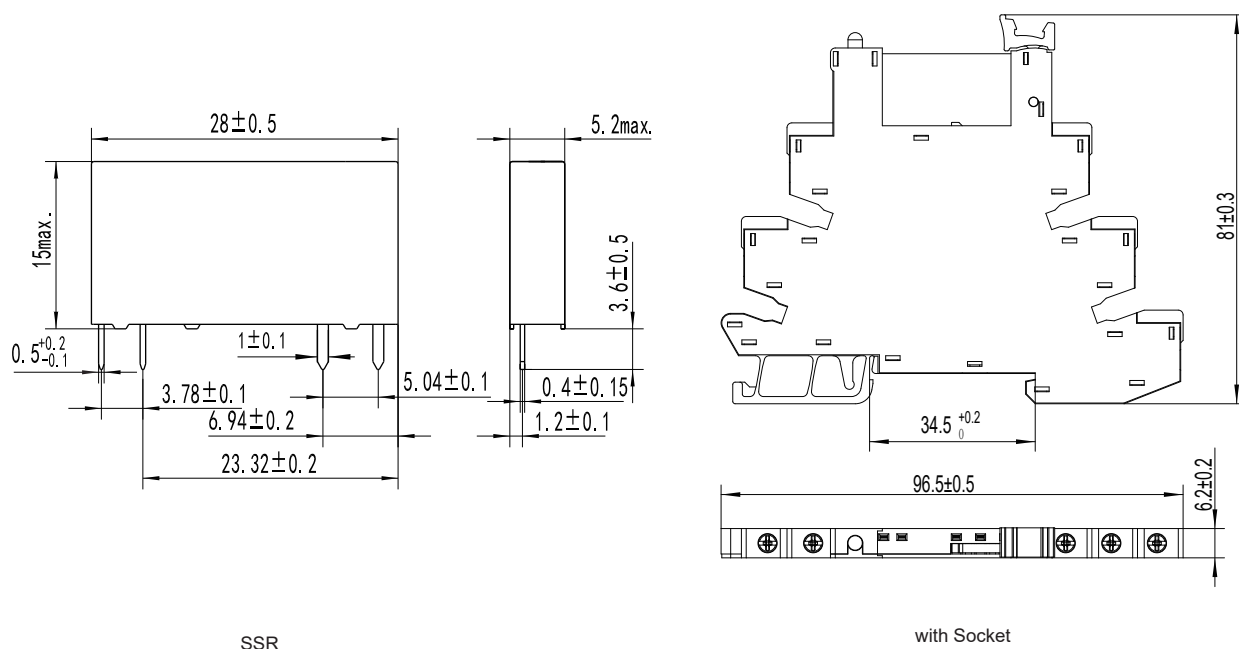

Wiring Diagram

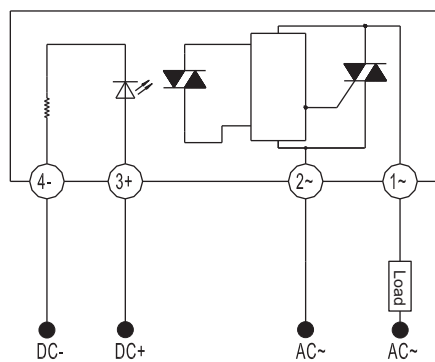

SSR

Wiring Diagram (with Socket)

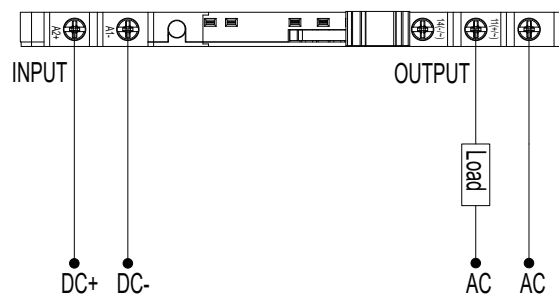

KSMA***-5D

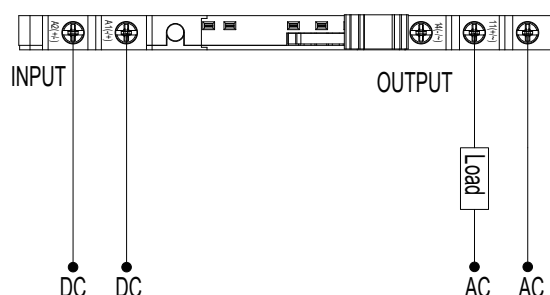

KSMA***-(12, 24) D

Thermal Derating Curve

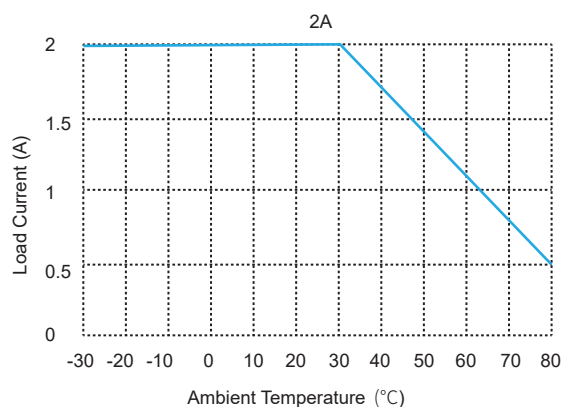
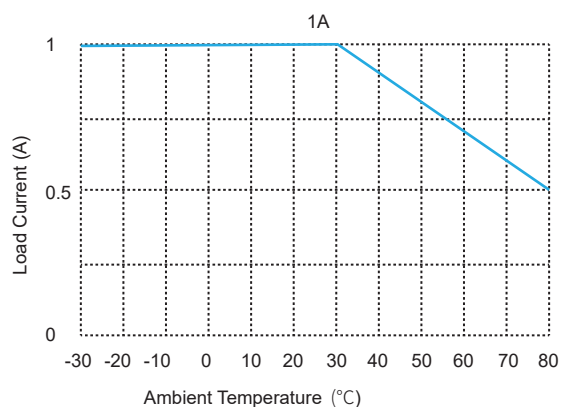

General Notes



1. Soldering must be finished within 10 seconds at 260°C, or finished within 5 seconds at 350°C. Otherwise it may cause damage to the relay.
2. When connecting wiring to SSR please ensure screws are torqued down properly 4.43/0.5 in lb/N·m
3. When ambient temperature is above 25°C, the maximum load current decreases. See thermal derating curve.

Agency Approvals (Certification)



Trademark Change Notification

Due to the company's strategic development needs, Xiamen Kudom Electronics Technology Co., Ltd will be acquired by i-Autoc (Xiamen) Investment Co., Ltd from 1st of July 2019. After the acquisition, all the products by Xiamen Kudom Electronics Technology Co., will no longer use Kudom trademark, but use i-Autoc trademark. The details of the change are as follows.

The original trademark  will be changed to . The original trademark  will still be used until 30th June 2019.

This is a change to the trademark only, the Company Name, Manufacturing Location, Management Team, Product Part Numbers and Safety Approval Licence Numbers (cUL, TUV, CCC, S-mark Etc) are to remain the same.