

EX 025 PAG



EX 045 LD PAG SP

V ~	12	24	48	110	240
V ≡				-	-
mA	27	20	20	17	18
IP 66	On ∞		°C -20 +50		
Ø 1" ISO 7/1					

## PAG PAG SP

Switches and pilot lights designed according to ATEX regulations, can be used in Group II explosive areas, Zones 1, 2, 21, 22.

**EX 025 PAG:** Explosion proof emergency switch ideal for activating alarm systems in explosive atmospheres, guaranteeing safety and long lifetime.

**EX 045 LD PAG SP:** Explosion proof pilot light, ideal for signaling the correct functioning of alarm/warning systems installed in explosive atmospheres.



**II 2GD Ex de IIC T6 Ex tD A21 IP66 T85 °C**

- Approval **CESI 05 ATEX 062**
- Housing in copper-free aluminium alloy
- Polyester paint RAL 3020
- Voltages available:
  - EX 045 LD PAG SP: 12V-24V-48V ACDC, 110V-240V AC
- Colors available: blue - amber - red - green - yellow - clear
- Protection: **IP 66**
- Maximum surface temperature: **T6**

EX 025 PAG

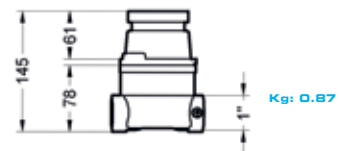

Kg: 0.87

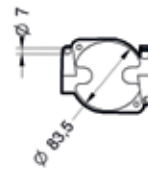

EX 045 LD PAG SP

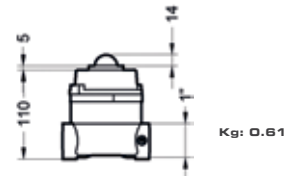

Kg: 0.61

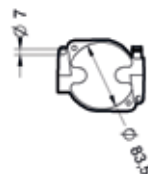

**CODES**

EX 045 LD PAG SP

	●	●	●	●	○
12V ACDC	97051	97053	97054	97055	97056
24V ACDC	97061	97063	97064	97065	97066
48V ACDC	97071	97073	97074	97075	97076
110V AC	97081	97083	97084	97085	97086
240V AC	97091	97093	97094	97095	97096

EX 025 PAG

96699