

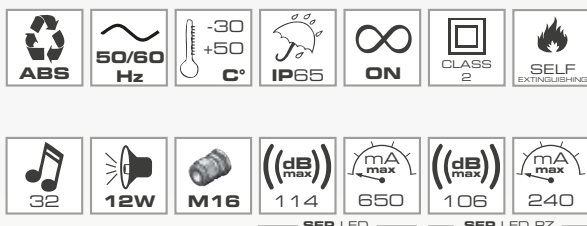

SEP LED MS32
SEP LED MS32 PZ



> 114 dB max <
> MULTI-TONE <
> with LED LIGHT <



SEP LED MS32 | PART NO

GY	
24V ACDC	50901
110V AC	50903
240V AC	50904

SEP LED MS32 PZ | PART NO

GY	
24V ACDC	50911
110V AC	50913
240V AC	50914

SEP LED MS32

Multifunctional electronic sirens with LED light engineered for industrial applications.

Developed with 12W magnetodynamic unit (SEP LED MS32) and with piezoelectrical unit (SEP LED MS32 PZ).

These electronic sirens benefit from 32 different tones, selectable via dip-switch and allow volume level (from min. to max.) and sound progression regulation (time required to reach the sound level set).

Ideal choice for industrial applications, from general-purpose signalization to warning of impending dangers.

KEY CHARACTERISTICS

NUMBER OF TONES

32 (Mixed tones)

VOLTAGES

24V ACDC, 110V AC, 240V AC +/-10%

PROTECTION GRADE

IP65

OPERATING TEMPERATURE

-30/+50 °C

MECHANICAL FEATURES

ABS body and sound speaker
Wall mounting (screws not included)

ACOUSTIC FEATURES

SEP LED MS32: 12W magnetodynamic unit

SEP LED MS32 PZ: piezoelectrical unit

32 tones selectable via dip-switch (frequency range 300/2850Hz)

OPTICAL FEATURES

8 red LEDs producing a flashing light effect

DRAWINGS, DIMENSIONS AND WEIGHTS

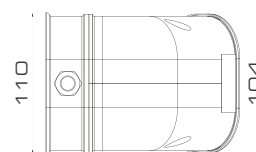
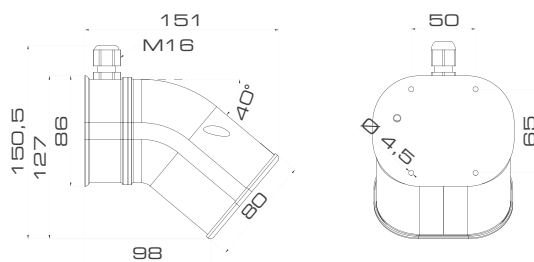

SEP LED	SEP LED 24V	SEP LED PZ	SEP LED PZ 24V
kg	kg	kg	kg
0,98	0,75	0,52	0,41

CERTIFICATIONS

